



# WESTWIND

## YACHT SALES

Victoria Harbour (Georgian Bay), Ontario

Contact: Brenda Flower

Tel: (705) 528-9979

Email: [westwind@csolve.net](mailto:westwind@csolve.net)

[www.westwindyachtscanada.com](http://www.westwindyachtscanada.com)

### Ocean Yachts 46 Sunliner - 1983

**SOLD!**



LOA	46' 0"	Beam	15' 2"
Draft	3' 6"	Fuel	480 US gal
Water	150 US gal	Waste	100 US gal
Clearance	13' 3"	Weight	40,000#
Headroom	6' 3"	Hull Type	Modified-V
Power	Twin Detroit 6-71 TIB 485HP, 1875 Hours		

#### Accommodations

**General:** Satin finish teak paneling and joinery throughout, vinyl teak and holly flooring, neutral salon carpets, off-white headliners and wall coverings

**Aft Cabin:** Walk-around queen bed with storage below, port and starboard drawer storage, side shelves, hanging lockers (3), opening side windows with screens, blinds and curtains, opening aft hatch with screen, en-suite with separate shower compartment, electric flush toilet

**Forward Stateroom:** Walk-around queen bed with storage below, side storage cabinets, overhead storage cabinets, hanging lockers (3), armoire, full-length mirror, overhead hatch with fan, direct access to shared forward head

**Forward Head:** Vanity with mirrored cabinets, electric flush toilet, separate shower compartment

**Salon:** Convertible Ultraleather sofa and recliner chair, glass-top coffee table, teak end table, entertainment centre with concealed TV, large opening side windows with blinds, stepped-down galley and convertible dinette, carpeted teak staircases with handholds

**Aft Deck:** Fully enclosed with hardtop and acrylic wing doors, canvas side curtains with sun shades, resin patio furniture set, teak end table, molded steps to bridge, transom gate access to swim platform, fitted marine carpet

**Bridge:** Full canvas enclosure, centre-line helm, double-wide helm seat, passenger bench forward of helm, Passenger lounge seat to starboard, fitted marine carpet, radar/equipment arch

#### Galley

Ample storage above and below counter  
3-burner propane stove with oven  
Built-in microwave oven  
Upright fridge/freezer (110v/propane)  
Under counter fridge (100v/propane)  
Stainless steel sink with garburator

#### Navigation Aids/Electronics

Garmin GPSmap 4212 chart plotter/radar

Autohelm ST3000 auto pilot

Interphase Twin Scope forward-looking sonar

Uniden VHF radio w/DSC plus back-up VHF

Apelco hailer with new cowl-mounted speaker

Engine synchronizer (slave arm)

#### Equipment

Westerbeke generator

Inverter

Air/reverse heat (3-zone)

Bow thruster

All-chain electric anchor windlass w/helm and bow controls

30kg claw anchor with 150' chain rode

Boom lift atop aft deck (1000 lbs capacity)

Dual 30 amp shore power service with two 50' cords

Batteries: 4 x 6v golf cart deep cycle (house/inverter)

4 x 12v starting (main engines)

1 x 12v starting (generator)

1 x 12v windlass and bow thruster

1 x 12v spare

Promariner 15-Amp 3-bank battery charger w/monitor

Dockside water inlet

Electric flush marine toilets (rebuilt 2020)

Stainless steel holding tanks (2)

Water and waste tank monitors

Raw water washdown (bow)

Automatic fire suppression (engine compartment)

RACOR fuel filters for main engines

AM/FM/CD stereos (salon and bridge)

Flat panel TV with surround sound and satellite receiver

Washer and dryer

Rail-mounted propane BBQ

Existing safety and mooring equipment

Existing manuals

All details are believed to be correct, but not guaranteed by owner or Broker. Some information may have been sourced from manufacturer's brochures. It is the Purchaser's responsibility to have all engines, systems and integrity of the vessel inspected.



# WESTWIND YACHT SALES

Victoria Harbour (Georgian Bay), Ontario

Ocean Yachts, founded in 1977, started building Superior Sportfishing vessels ranging from 37' to 73' feet. Today, with attention to detail and continual innovation, they continue to build some of the finest fishing and cruising yachts on the water. In 2016 Ocean Yachts became part of the Egg Harbour group, which owns a number of the top brands manufactured today.

Like all Ocean designs, the Sunliner is based on a low-deadrise, modified-V hull with a distinctive sweeping sheer and well-flared bow. Originally designed for open cockpit off-shore sport fishing, the Sunliner models replaced the open cockpit with an aft cabin and hardtop aft deck to create comfortable cruising accommodations with a two-stateroom layout.

"La Vida Loca" has been a Great Lakes freshwater boat for over 20-years. Her hull above the water line has been professionally refinished and shines like new, and her exterior teak accents, including teak toe rails, are nicely finished with only minor scuffing here and there from dock line abrasion. Below decks, the interior has been completely updated and tastefully decorated in neutral colour tones. Both staterooms have walk-around queen berths and the heads have separate showers. A key feature is the fully enclosed aft deck which provides a great space protected from the elements for casual entertaining. A few steps up, the canvas-enclosed bridge provides a commanding view for the helmsman with passenger seating for 6-8

Power underway is provided by a pair of 685HP turbo-charged Detroit diesels, highly regarded for reliability and serviceability along with super fuel economy. Both were tuned and fitted with new injectors in Sep. 2020. A bow thruster provides added maneuverability around the docks. The package includes a Genco custom fitted winter cover and frame, and a paid-up marina slip, including winter storage.

Whether your dream is comfortable, laid-back cruising, casual weekend entertaining or finding a full-time live-aboard, "La Vida Loca" may just be the perfect fit.

**Vessel located off-site. Please call ahead to schedule a viewing appointment**

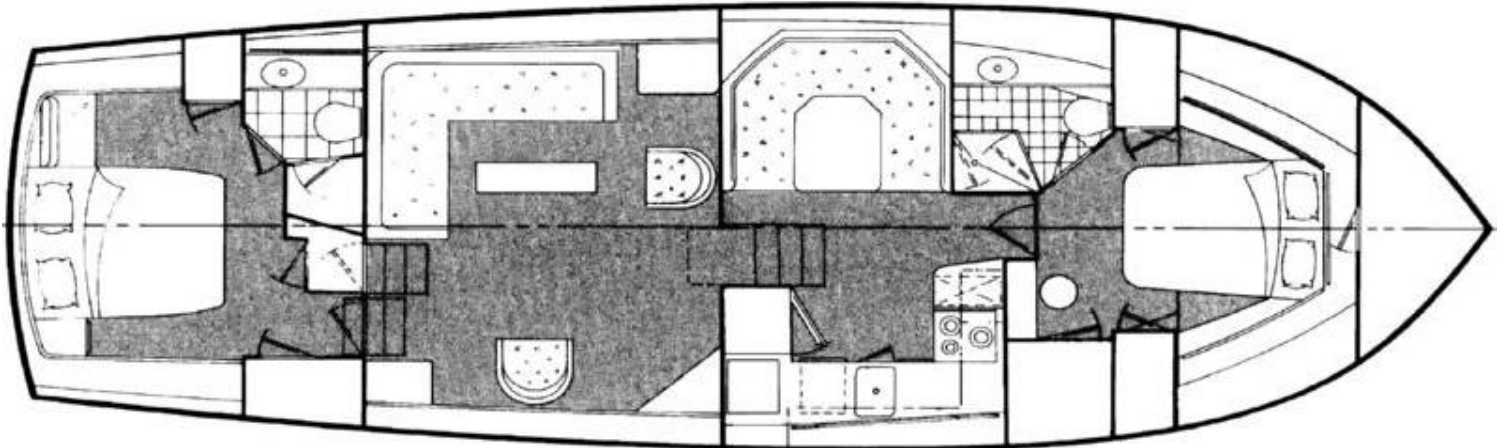

All details are believed to be correct, but not guaranteed by owner or Broker. Some information may have been sourced from manufacturer's brochures. It is the Purchaser's responsibility to have all engines, systems and integrity of the vessel inspected.